



Installation Guidelines

4 PIECE SPLIT TUB WITH WALLS

IMMEDIATELY INSPECT UNIT UPON RECEIPT FOR DAMAGES AND REPORT TO THE CARRIER.

PROTECTIVE GLOVES SHOULD BE WORN WHEN HANDLING A FIBERGLASS UNIT TO PROTECT FROM FIBRES.

PREPARATION & INSTALLATION

1. Prepare the framing area to suit the appropriate length and width of your Altrek bathtub. Ensure your framing is square and allow at least 1/4" clearance to slide unit into place.
2. Remove crating and disassemble unit. **DO NOT REMOVE RED PINS.** Move pieces into bathroom.
3. Install waste and overflow kit (supplied by others) to bathtub, place unit into framed area and level. If necessary, shim to proper height for floor material specified. Shims or supports under the bathtub may be required. Mark and pre-drill pilot holes in the nailing flange for securing screws. **(Note: failure to pre-drill may result in stress cracks to the gelcoat finish)**

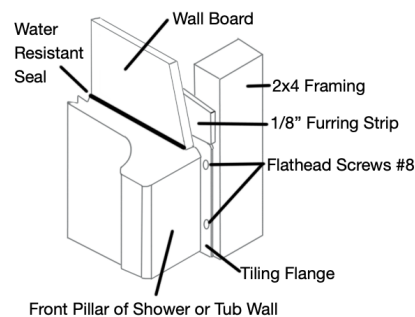
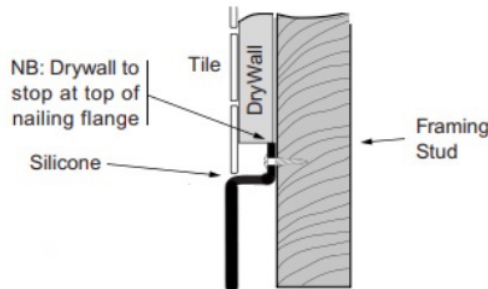

4. Attach the bathtub with screws to each stud. Use screws that are long enough to penetrate the studs if installing over previously installed drywall, or into a firewall pocket installation.
5. Place back wall first onto bathtub and secure top flange to studs with screws. Again, pre-drill pilot holes in the nailing flange for securing screws. **(Note: failure to pre-drill may result in stress cracks to the gelcoat finish)**
6. Install side wall (left or right) directly over **RED PINS** and secure to studs. Repeat opposite side wall.
7. Drill holes for valve and spout in accordance with rough-in instructions. (Supplied by others)

8. Apply a bead of silicone to all seams and let dry for 24 hours before use. **Hint:** Run painters tape on both sides of the seam approximately ¼" apart for a clean straight bead line. Peel tape after running your finger on the bead. Always wash your hands prior to touching the silicone to eliminate transferring dirt on to the silicone bead.

DRYWALLING

Our recommended drywall system is to butt the bottom of the drywall up to the top of the nailing flange: if tile is being used as the finished surface, the tile can then project over the edge of the drywall, down to the horizontal ledge, 1" above the surface of the tub. Alternatively, the drywall may be painted. In any case, a bead of silicone should be run above the bottom edge as a sealant and gap filler. *See diagram on first page.*

CARE & MAINTENANCE

The following hints on care and maintenance are offered to assist you in keeping your tub or shower in "as new" condition.

NORMAL CARE: A quick sponge down with warm water and non-abrasive liquid detergent such as Mr. Clean, Fantastic or Lysol Tub & Tile Cleaner will take care of most cleaning needs. In areas where the water is hard, more frequent cleaning may be necessary to avoid a build-up on the surface.

STAINS: For stubborn stains, start with a liquid detergent, if this does not work, try a mild cleaning detergent such as Vim, which also works well for removing heavy soap film. Cleaning pads made of nylon, saran, polyethylene and containing no abrasive may be used. **DO NOT** use abrasive scouring powders or metal scouring pads, they can permanently damage the finish.

DULL AREAS: Should your stain removal result in a dull area, the shine can be restored with automobile wax such as Turtle Wax.

PAINT SPLASHES: A quick wipe with Acetone, mineral spirits or turpentine followed by a wash with water will remove paint. Do not use paint remover or stripper as these contain solvents with could permanently damage the surface.

THINGS TO AVOID: SAND AND GRIT, DROPPED TOOLS, LADDERS OR ANY OTHER CONSTRUCTION DEBRIS.

DAMAGES: Should your unit suffer accidental damage, consult your plumber, wholesaler or Altrek for a qualified repair person to deal with the issue. Do not attempt to repair the unit on your own.



LIMITED WARRANTY

All Altrek products are subject to an industry competitive limited warranty. Altrek Industries Ltd. offers a five (5) year warranty from date of purchase to the original owner on our products. This warranty does not cover materials and component parts manufactured by others (such as pumps, jets, pipes and fittings). Altrek Industries Ltd. warrants to the purchaser that each Altrek product will be at any time of sale, free from defect in material and workmanship.

Under no circumstances will Altrek Industries Ltd. assume liability for consequential damages or labor charges resulting there from. This warranty is non-transferable and shall be void if the unit is removed from its place of initial installation or is not installed in accordance with the manufacturer's instructions. Further, this warranty does not apply if the unit has been subject to an accident, abuse, misuse, damage caused by flood, fire, or act of Nature, or if the unit or the plumbing fixtures used in connection with it are not installed in compliance with local codes. Any modifications or alterations to a unit, without prior authorization from Altrek Industries Ltd. or the installation of therapy jets by anyone other than Altrek, will void all warranties.



SINCE 1986

STRONG. SLEEK. DEPENDABLE & BUILT TO LAST

136 Fisher Street PO Box 822

Okotoks, Alberta T1S 1A9

403.938.2448

sales@altrekproducts.com