



Installation Guidelines

BASES

IMMEDIATELY INSPECT UNIT UPON RECEIPT FOR DAMAGES AND REPORT TO THE CARRIER.

PROTECTIVE GLOVES SHOULD BE WORN WHEN HANDLING A FIBERGLASS UNIT TO PROTECT FROM FIBRES.

PREPARATION & INSTALLATION

1. Prepare the framing area to suit the appropriate length and width of your Altrek base. Ensure your framing is square and allow at least $\frac{1}{4}$ " clearance to slide unit into place.
2. Move unit into place and if necessary, shim to proper height for floor material specified. Shims or supports under the shower may be required. Unit may be installed through the open side of the framed pocket or through the end wall. When installing through open side, align lower edge of threshold in approximate position and tilt back.

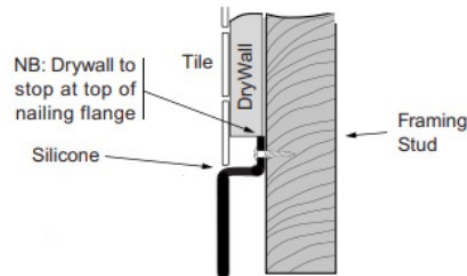

3. Remove unit and install drain kit (Supplied by others). A cut-out in the floor may be required to accommodate the drain fitting.
4. Re-install unit into place. Mark and pre-drill pilot holes in the nailing flange for securing screws. **(Note: failure to pre-drill may result in stress cracks to the gelcoat finish)** See above diagram.
5. Attach the base with screws to each stud. Use screws that are long enough to penetrate the studs if installing over previously installed drywall, or into a firewall pocket installation. Extra support under the base may be required.

DRYWALLING

Our recommended drywall system is to butt the bottom of the drywall up to the top of the nailing flange: if tile is being used as the finished surface, the tile can then project over the edge of the drywall, down to the horizontal ledge, 1" above the surface of the tub. Alternatively, the drywall may be painted. In any case, a bead of silicone should be run above the bottom edge as a sealant and gap filler. *See diagram above.*

CARE & MAINTENANCE

The following hints on care and maintenance are offered to assist you in keeping your tub or shower in "as new" condition.

NORMAL CARE: A quick sponge down with warm water and non-abrasive liquid detergent such as Mr. Clean, Fantastic or Lysol Tub & Tile Cleaner will take care of most cleaning needs. In areas where the water is hard, more frequent cleaning may be necessary to avoid a build-up on the surface.

STAINS: For stubborn stains, start with a liquid detergent, if this does not work, try a mild cleaning detergent such as VIM, which also works well for removing heavy soap film. Cleaning pads made of nylon, saran, polyethylene and containing no abrasive may be used. DO NOT use abrasive scouring powders or metal scouring pads, they can permanently damage the finish.

DULL AREAS: Should your stain removal result in a dull area, the shine can be restored with automobile wax such as Turtle Wax.

PAINT SPLASHES: A quick wipe with Acetone, mineral spirits or turpentine followed by a wash with water will remove paint. Do not use paint remover or stripper as these contain solvents with could permanently damage the surface.

THINGS TO AVOID: SAND AND GRIT, DROPPED TOOLS, LADDERS OR CONSTRUCTION DEBRIS.

DAMAGES: Should your unit suffer accidental damage, consult your plumber, wholesaler or Altrek for a qualified repair person to deal with the issue. Do not attempt to repair the unit on your own.